

HellermannTyton

INSEHWM

Installation Instructions for Enhanced Horizontal Wire Managers

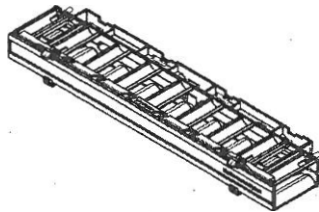

EHWMN1

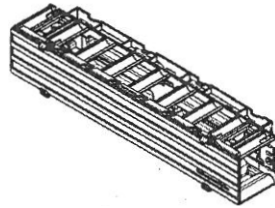

EHWM1

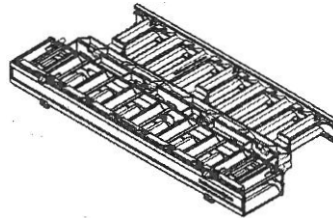

EHWMN2

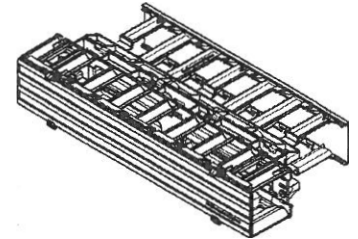

EHWM2

Install the manager on the rack with the four provided # 12-24 screws and washers.

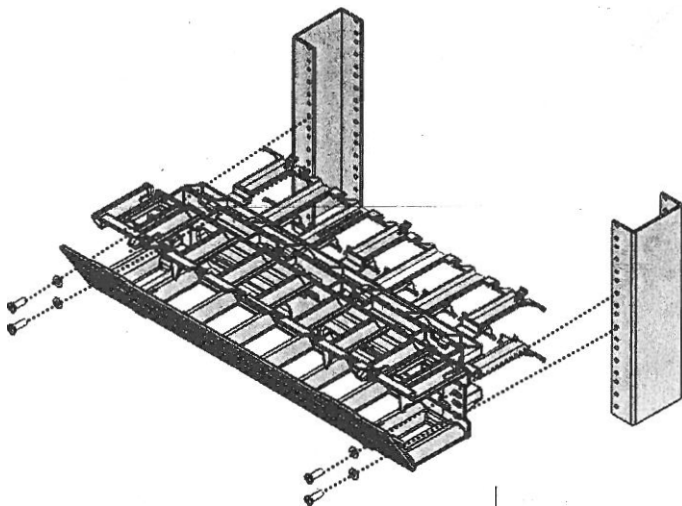

Fill Capacity Chart

Part Number	UTP cable 0.187" Dia.		CAT 6/ScTP 0.25" Dia.		Fiber 3mm Dia.	
	Front	Back	Front	Back	Front	Back
EHWM1	108		60		276	
EHWM2	108	96	60	48	276	240
EHWMN1	36		18		72	
EHWMN2	36	24	18	12	72	48

Note: Based on a 40% fill capacity

Route cables as shown below to maintain proper cable bend radius

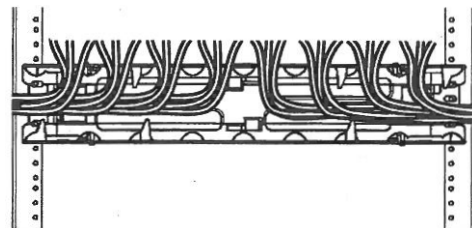

To release cover, push downward on latches

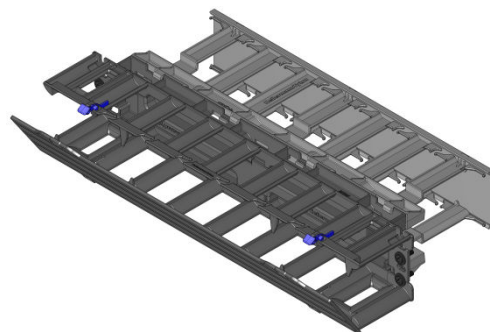
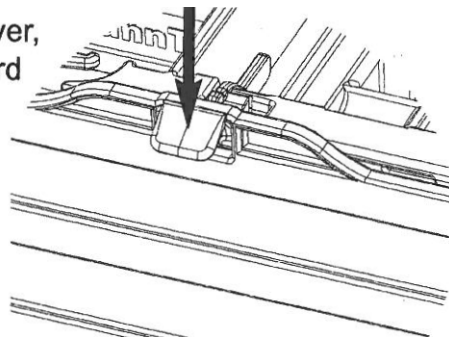

HellermannTyton
 7930 N. Faulkner Road • Milwaukee, WI 53224
 Phone: 800-537-1512 • Fax: 800-848-9866
www.hellermanntyton.us
 Specification Website: www.htnetwork.com